



3LION SYSTEM

DATA SHEET
Model: 3L-150-P



MAIN FEATURES

- FAST CHARGING, UP TO 75A FOR EACH HOUR OF TRAVEL
- LONG LIFETIME, OVER 2500 CYCLES
- VERY HIGH POWER DENSITY AND ENERGY
- WEIGHT -60% THAN A TRADITIONAL BATTERY
- SUPER SECURE AND RELIABLE
- EXEMPT FROM SULFATION AND MAINTENANCE
- LOW DISCHARGE (LESS THEN 3%/MONTH)

3LION SYSTEM" INCLUDES

- 3LION - LIFEPO4 - BATTERY WITH INTEGRATED BMS
- 3LINK - ADVANCED BMS MANAGER
- DISPLAY - CONTROL THE WHOLE 3LION SYSTEM

PROTECTIONS

- OVER CHARGE PROTECTION
- OVER DISCHARGE PROTECTION
- OVERCURRENT PROTECTION
- SHORT CURRENT PROTECTION
- TEMPERATURE PROTECTION

This technical data sheet is indicative. NDS Energy reserves the right to make changes at any time, without notice, for technical or commercial reasons to the illustrated articles.

Date of last update: 01/09/2017



TUTTA L'ENERGIA CHE TI SERVE
ALL THE ENERGY YOU NEED

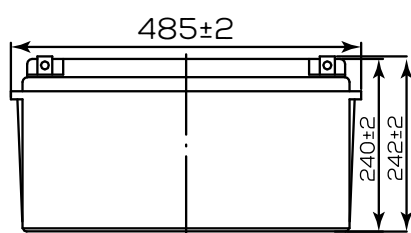

SIDE 1

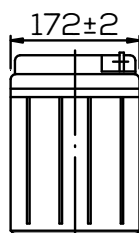

SIDE 2

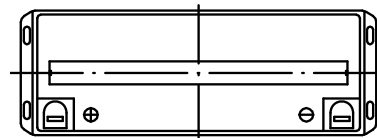

SUPERIOR

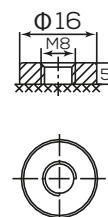

**TERMINAL
F12**

BATTERY DATA

MODEL	L-150-P
NOMINAL VOLTAGE	12,8V DC
CAPACITY AT 25°C	150AH
NOMINAL ENERGY AT 25°C	1920WH
NUMBER OF CELLS	4
CHEMISTRY	LiFePO ₄
MAXIMUM DISCHARGE CURRENT (RACCOMANDED)	150A
MAXIMUM DISCHARGE CURRENT (SUPPORTED)	300A/10 SECONDI
END DISCHARGE VOLTAGE	10V±0.1V
MAXIMUM CHARGING CURRENT (RACCOMANDED)	75A/0.5C
MAXIMUM CHARGING CURRENT (SUPPORTED)	150A/1C
END CHARGING VOLTAGE	14.4V±0.2V
ESTIMATED CYCLE NUMBER 80% DOD	2500*
WORKING TEMPERATURE (DISCHARGE)	-20°C/+60°C
WORKING TEMPERATURE (CHARGE)	0°C/+45°C
STORAGE TEMPERATURE	0°C/+40°C
TERMINAL CONNECTION	F12
WEIGHT (BATTERY ONLY)	20,2 KG (44,54 LBS)
SIZE (ONLY BATTERY)	485X172H240 MM
SIZE (BATTERY+PACKAGING)	525X210H280 MM

* THE NUMBER OF CYCLES IS PURELY INDICATIVE, IT DEPENDS ON VARIOUS FACTORS, SUCH AS: ENVIRONMENTAL CONDITIONS, DISCHARGE DEPTH, CHARGE/DISCHARGE CURRENT, ETC...

SELF DISCHARGE

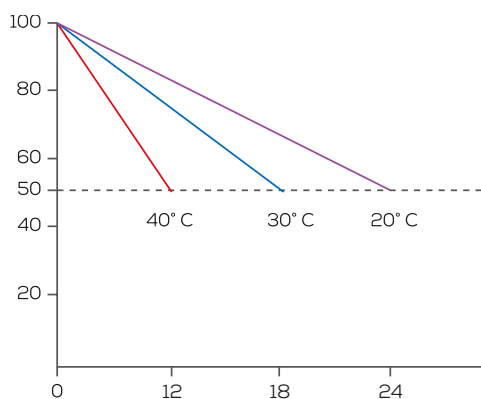

**CYCLE LIFE RELATED TO
THE DEPTH DISCHARGE**

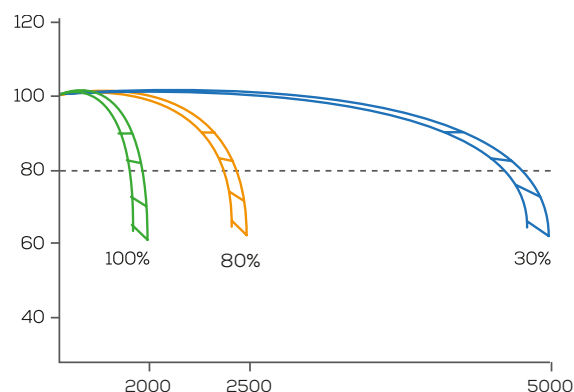

This technical data sheet is indicative. NDS Energy reserves the right to make changes at any time, without notice, for technical or commercial reasons to the illustrated articles.

Date of last update: 01/09/2017



TUTTA L'ENERGIA CHE TI SERVE
ALL THE ENERGY YOU NEED

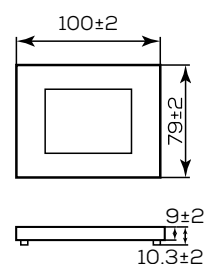
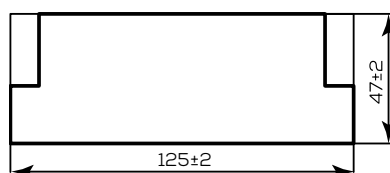
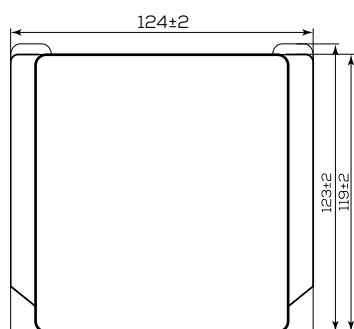

3LINK DATA

WORKING VOLTAGE	12V (9V-18V)
AVERAGE CONSUMPTION	3 mA @ 12V @ WORKING DEVICE 1 mA @ 12V @ STAND-BY DEVICE
MAXIMUM SUPPORTED CURRENT	200A
WORKING TEMPERATURE	-20°C/+65°C
MAXIMUM CURRENT, AUX EXIT	30 mA
CURRENT RANGE	-200A/+200A ±10%
TOLERANCE VOLTAGE BATT. ENGINE, BATT. 3LION	±5%
SIZE	125X123X47 mm
WEIGHT	480G

DISPLAY DATA

TECHNOLOGY	TFT 2,83" 262K COLORS WITH TOUCH SCREEN
AVERAGE CONSUMPTION	76 mA @ 12V MAXIMUM BRIGHTNESS 7 mA @ 12V STAND-BY
CONNECTION TYPE	7M CABLE WITH LOW-PROFILE CONNECTOR
WORKING TEMPERATURE	-10°C/+70°C
SIZE	100X79X11 mm
WEIGHT	55G

This technical data sheet is indicative. NDS Energy reserves the right to make changes at any time, without notice, for technical or commercial reasons to the illustrated articles.
Date of last update: 01/09/2017



TUTTA L'ENERGIA CHE TI SERVE
ALL THE ENERGY YOU NEED